

10 Abmessungen

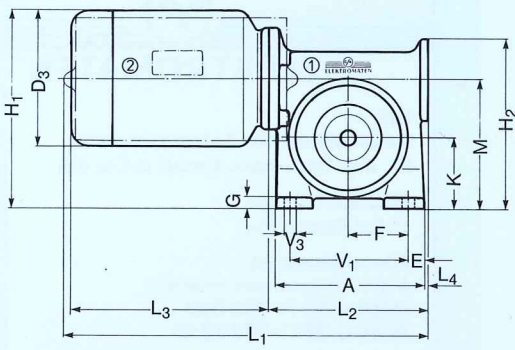

- ① Schneckengetriebe (gezeichnet Abtrieb links)
- ② Motor
- ③ Wendeschützsteuerung mit Gleichrichter für magnetische Verriegelung
- ④ Endschalter
- ⑤ Handrad für Rutschkupplung
- ⑥ Magnetische Verriegelung 96 V-

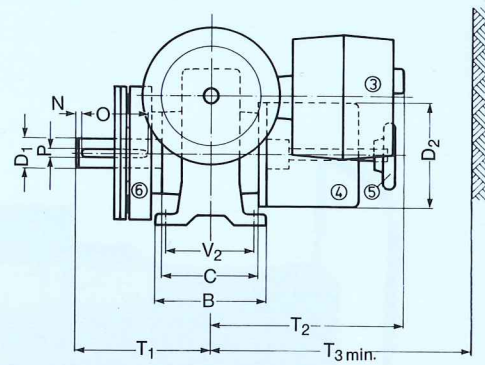

| Größe | A   | B   | C   | D <sub>1</sub> | D <sub>2</sub> | D <sub>3</sub> | E  | F   | G  | H <sub>1</sub> | H <sub>2</sub> | K   | L <sub>1</sub> | L <sub>2</sub> | L <sub>3</sub> | L <sub>4</sub> | M   | N | O  | P  | T <sub>1</sub> | T <sub>2</sub> | T <sub>3</sub> | T <sub>4</sub> | V <sub>1</sub> | V <sub>2</sub> | V <sub>3</sub> | V <sub>4</sub> | V <sub>5</sub> | V <sub>6</sub> | W   | X   | a1  | a2  | b1 | c1  | d1  | e1  | f1  | g1 | k1  |
|-------|-----|-----|-----|----------------|----------------|----------------|----|-----|----|----------------|----------------|-----|----------------|----------------|----------------|----------------|-----|---|----|----|----------------|----------------|----------------|----------------|----------------|----------------|----------------|----------------|----------------|----------------|-----|-----|-----|-----|----|-----|-----|-----|-----|----|-----|
| 01    | 150 | 120 | 75  | 25             | 125            | 130            | 10 | 56  | 15 | 194            | 160            | 72  | 405            | 195            | 210            | -              | 132 | 3 | 50 | 8  | 138            | 193            | 268            | 145            | 120            | 98             | 11             | 240            | 240            | 400            | 510 | 360 | 60  | 60  | 25 | 55  | 100 | 150 | 180 | 25 | 130 |
| 02    | 150 | 120 | 75  | 25             | 125            | 145            | 10 | 56  | 15 | 202            | 160            | 72  | 405            | 195            | 210            | -              | 132 | 3 | 50 | 8  | 138            | 203            | 278            | -              | 120            | 98             | 11             | 240            | 240            | 400            | 510 | 360 | 60  | 60  | 25 | 55  | 100 | 150 | 180 | 25 | 130 |
| 03    | 150 | 120 | 75  | 25             | 125            | 145            | 10 | 56  | 15 | 202            | 160            | 72  | 405            | 195            | 210            | -              | 132 | 3 | 50 | 8  | 138            | 203            | 278            | -              | 120            | 98             | 11             | 240            | 240            | 400            | 510 | 360 | 60  | 60  | 25 | 55  | 100 | 150 | 180 | 25 | 130 |
| 1     | 175 | 130 | 114 | 35             | 136            | 162            | 20 | 70  | 15 | 235            | 203            | 85  | 430            | 188            | 234            | 4              | 154 | 5 | 90 | 10 | 170            | 221            | 296            | 180            | 140            | 105            | 13             | 175            | 200            | 570            | 650 | 400 | 125 | 100 | 45 | 0   | 120 | 280 | 200 | 25 | 157 |
| 2     | 175 | 130 | 114 | 35             | 136            | 162            | 20 | 70  | 15 | 235            | 203            | 85  | 430            | 188            | 234            | 4              | 154 | 5 | 90 | 10 | 170            | 221            | 296            | -              | 140            | 105            | 13             | 175            | 200            | 570            | 650 | 400 | 125 | 100 | 45 | 0   | 120 | 280 | 200 | 25 | 157 |
| 3     | 195 | 150 | 130 | 40             | 136            | 181            | 28 | 72  | 18 | 259            | 216            | 85  | 497            | 215            | 282            | 10             | 168 | 5 | 90 | 12 | 170            | 227            | 302            | 210            | 145            | 125            | 13             | 175            | 200            | 570            | 650 | 400 | 125 | 100 | 45 | 0   | 120 | 280 | 200 | 25 | 157 |
| 4     | 250 | 200 | 162 | 50             | 136            | 203            | 17 | 108 | 18 | 324            | 272            | 122 | 647            | 335            | 312            | -              | 222 | 3 | 95 | 14 | 220            | 257            | 332            | 250            | 216            | 164            | 18             | 400            | 400            | 630            | 810 | 470 | 35  | 35  | 32 | 147 | 100 | 280 | 235 | 90 | 190 |
| 5     | 250 | 200 | 162 | 50             | 136            | 203            | 17 | 108 | 18 | 324            | 272            | 122 | 647            | 335            | 312            | -              | 222 | 3 | 95 | 14 | 220            | 257            | 331            | -              | 216            | 164            | 18             | 400            | 400            | 630            | 810 | 470 | 35  | 35  | 32 | 147 | 100 | 280 | 235 | 90 | 190 |
| 6     | 285 | 205 | 200 | 50             | 136            | 228            | 27 | 115 | 20 | 372            | 311            | 132 | 754            | 393            | 335            | -              | 257 | 5 | 80 | 16 | 237            | 275            | 350            | -              | 230            | 170            | 18             | 400            | 400            | 630            | 810 | 470 | 35  | 35  | 60 | 141 | 100 | 280 | 235 | 90 | 190 |

Antrieb neu:

3.2 ST 16.15 - ST 30.24

SG85R

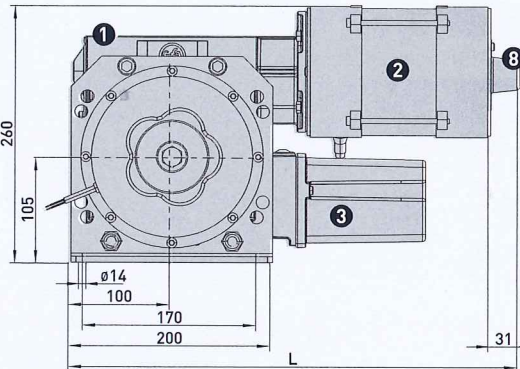
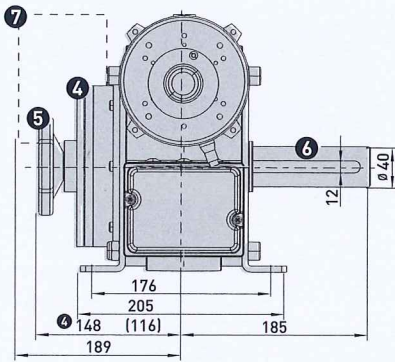

- ① Schneckenradgetriebe mit Rutschkupplung
- ② Motor
- ③ Klemmraum / optional: integrierter Endschalter
- ④ Magnetbremse
- ⑤ Handrad für Rutschkupplungseinstellung
- ⑥ Abtriebswelle (umsteckbar)
- ⑦ Optional: Torsteuerung WS 905
- ⑧ Abdeckung

| ELEKTROMATEN | L   |
|--------------|-----|
| ST 16.15     | 457 |
| ST 16.24     | 431 |
| ST 30.15     | 494 |
| ST 30.24     | 480 |

■ Zulässige Einbaulage: waagrecht (wie dargestellt) oder senkrecht (Motor nach oben)

3.3 ST 60.15 - ST 80.24

SG115R

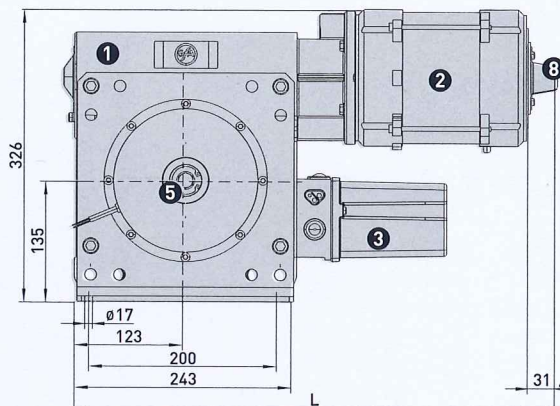
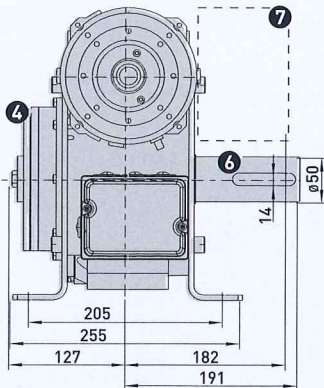

- ① Schneckenradgetriebe mit Rutschkupplung
- ② Motor
- ③ Klemmraum / optional: integrierter Endschalter
- ④ Magnetbremse
- ⑤ Einstellung Rutschkupplung (SW 17)
- ⑥ Abtriebswelle (umsteckbar)
- ⑦ Optional: Torsteuerung WS 905
- ⑧ Abdeckung

| ELEKTROMATEN | L   |
|--------------|-----|
| ST 60.15     | 559 |
| ST 60.24     | 534 |
| ST 80.15     | 579 |
| ST 80.24     | 559 |